

VIBRANCE™ DYE

TECHNICAL DATA SHEET



DESCRIPTION

Vibrance™ Dye is a cutting-edge, acetone-based concrete dye, expertly crafted for enriching indoor and outdoor surfaces with durable, vivid color. This dye's super fine powder formula allows for straightforward mixing and versatile application, enabling professionals to achieve deeply saturated hues. What sets Vibrance™ Dye apart is its exceptional capability for color correction, allowing for seamless blending and repair of color inconsistencies or imperfections in existing concrete projects. Coupled with its outstanding UV resistance, it ensures that colors stay vibrant and fade-resistant, even when exposed to sunlight. Perfect for a myriad of decorative concrete applications, from enhancing residential spaces to commercial settings and detailed architectural elements, Vibrance™ Dye combines superior color stability, ease of transportation in its powder form, and unparalleled color correcting properties, making it an indispensable tool for professionals seeking perfection in concrete finishes.

PRODUCT BENEFITS

- **Exceptional Penetration and Durability:** The product's advanced formula allows for deep infusion into the concrete's pores, depositing micronized pigments for durable, mottled finishes. This ensures color consistency and longevity.
- **Versatile Color Selection:** With thirty-five available colors, Vibrance™ Dye offers a wide range of hues for transforming plain concrete into vibrant and aesthetically pleasing surfaces.
- **Suitable for Various Applications:** Vibrance™ Dye's versatility is suitability for a range of applications, from interior floors to outdoor patios.
- **Color Enhancement Options:** ColorWave® Stain can be applied over other concrete treatments to enhance the tone of colored concrete.

PRE-APPLICATION

- **Clean:** Vibrance™ Dye should be applied only on clean surfaces devoid of dust, dirt, oil, grease, paint, adhesive, sealers, curing compounds, efflorescence, chemical pollutants, rust, algae, and mildew, which could interfere with the chemical reaction. Clean the surface with an eco-friendly degreaser and ensure thorough rinsing with clean water to remove any residues.
- **Sound:** Apply only to cement-based products that are not flaking or spalling. The substrate must be structurally sound. For surfaces showing signs of delamination, employ diamond grinding, shot blasting, or similar mechanical methods for removal. For concrete, ensure the surface has a minimum strength of 2500 psi.
- **Cured:** The concrete or overlay must be fully cured prior to application. For optimal results, it is advised that cement-based products undergo a curing period of at least 28 days.
- **Temperature:** Apply when temperatures are between 40°F (4°C) and 95°F (35°C) for optimal results.
- **Profiled:** Conduct an absorption test to determine if the concrete is ready for staining. Pour water onto the surface and wait 3-5 minutes.

PREPARATION

- **Personal Safety:** Always wear appropriate personal protective equipment as recommended in the Safety Data Sheet.
- **Area Preparation:** Protect surfaces not intended for staining by covering surrounding areas to prevent accidental application.
- **Avoid using tape on concrete surfaces before or after staining,** as adhesives and plasticizers can interfere with the stain's effectiveness.

TOOLS REQUIRED

- **Personal Safety:** Always wear appropriate personal protective equipment as recommended in the SDS.

Preparation Tools

- ProClean Degreaser™
- Pressure washer
- Scrub brush/Broom/Mop/Bucket
- Wet/Dry vacuum
- Surface protector

Etching Tools (If Required)

- Safety gear
- Pump sprayer
- Spiked shoes
- CitrusEtch™ concrete etcher
- ProClean Neutralizer™
- Scrub Brush/Broom/Mop/Bucket
- Wet/Dry vacuum

Staining Tools & Supplies

- Safety gear
- Spiked shoes
- Acetone
- Acetone-grade sprayer
- Spill bucket & microfiber cloth

Sealing Tools

- Safety gear
- AcquaSeal™ or EasySeal™ concrete sealer
- Pump sprayer and/or 1/4 ' nap roller/tray

Polishing Tools (Interior Only)

- ProWax Polish™ concrete floor wax
- 1/4 ' Nap Roller/Tray

VIBRANCE™ DYE PREPARATION

Vibrance™ Dye is available in pre-measured packets for mixing with acetone in volumes of 5 ounces, 1 quart, 1 gallon, or 5 gallons. Follow these steps to ensure proper dye preparation:

1. Select the correct pre-measured dye:

Each container is pre-measured for a specific amount of acetone:

- For 5 oz of acetone: Use the 5-oz Vibrance™ Dye
- For 1 qt of acetone: Use the 1-qt Vibrance™ Dye
- For 1 gal of acetone: Use the 1-gal Vibrance™ Dye
- For 5 gal of acetone: Use the 5-gal Vibrance™ Dye

2. Pour:

Add the entire contents of the pre-measured dye container into a separate container with the indicated amount of acetone (5 oz, 1 qt, 1 gal, or 5 gal).

CAUTION: When preparing the concrete dye mixture with acetone, please exercise extreme care. **Do not** use an electrical mixer to blend the dye and acetone in the sprayer, as acetone is highly flammable, and this could create a fire hazard. Instead, use a manual stir stick or shake the container vigorously to ensure the dye is thoroughly mixed. Always handle and store acetone in a well-ventilated area, keeping it away from heat, sparks, and open flames. Be sure to follow all warnings and safety instructions provided on the acetone label.

3. Shake:

Tightly seal the container and shake it vigorously for at least 20 seconds to ensure the dye mixes thoroughly with the acetone.

4. Wait:

Let the mixture sit for one hour before use.

5. Spray:

Remove all filters from the acetone-grade sprayer, shake the Vibrance™ mixture well again, and pour it into the sprayer for application.

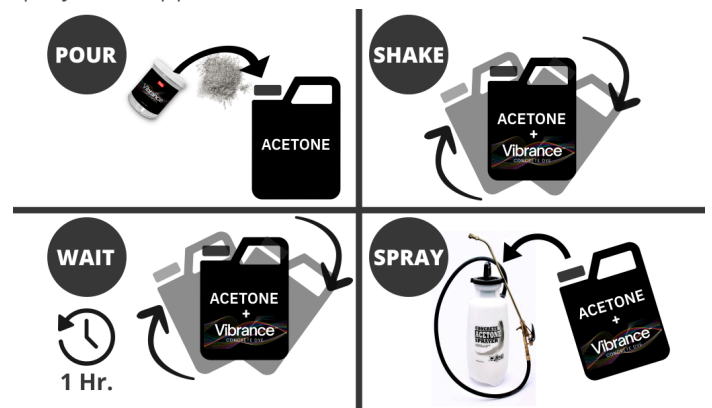

Note: Always use a sprayer specifically designed for acetone. Regular sprayers used for decks or fences won't work with this product.

VIBRANCE™ DYE APPLICATION

Before starting:

Ensure all sources of ignition are eliminated. Turn off any pilot lights, avoid smoking, and keep the area free from sparks or open flames. Always follow acetone safety guidelines as outlined on the product label.

Start at a far corner:

Begin spraying in the corner furthest from the exit to keep a clear path for leaving. Use an acetone-grade sprayer to prevent damage and ensure proper application.

Spray technique:

Spray in circular motions with overlapping passes for even coverage. Frequently shake the sprayer side to side to keep the dye mixed. When using multiple colors, apply lighter shades first, then blend with darker ones. Always wear spiked shoes to avoid disturbing the wet dye.

Apply Thin Coats:

Use thin coats to avoid puddling. You can apply up to four coats for deeper color, allowing each coat to fully dry before applying the next. If the sprayer drips or puddles form, stop and wait 4–6 hours for the dye to dry. Dab excess dye with a cotton cloth and acetone, then lightly respray to blend.

Drying Time:

Allow 8 hours between coats, and let the final coat dry for at least eight hours before applying the sealer. If you need to walk on the surface before it's fully dry, wear spiked shoes to avoid smudging.

Remove Excess Dye:

After the dye has dried, use a dust mop or microfiber mop to remove any excess dye that hasn't bonded to the surface.

Avoid Walking on Wet Dye:

Do not walk on the dye until it's fully dry. If necessary, wear socks or spiked shoes to prevent smudging.

Note: The color may appear faint when dry but will become more vibrant once the sealer is applied. Be patient and allow full drying time for best results. Applying the sealer is a crucial final step.

COVERAGE

Estimated coverage is approximately 150 square feet (13.94 m²) per gallon. Actual coverage rates may differ based on factors such as surface porosity, texture, the age and condition of the concrete, chosen application method, and prevailing environmental conditions.

CLEAN UP

For cleaning tools and equipment use acetone. Always follow acetone safety guidelines as outlined on the product label.

SEALING

Sealing is an essential step after applying Vibrance™ Dye. The dye itself penetrates the pores of the surface but does not form a permanent bond, meaning it can largely be washed off if not sealed.

FOR EXTERIOR SURFACES:

- Choose between EasySeal™ Satin or AcquaSeal™ Satin. Both provide a satin finish that is less slippery compared to their gloss counterparts.
- Keep in mind that EasySeal™, being solvent-based, generally enriches and darkens the stain color more than the water-based AcquaSeal™.

FOR INTERIOR SURFACES:

- AcquaSeal™, available in Gloss or Satin, is the recommended sealer for indoor use. Its water-based composition and lower VOC emissions make it an ideal choice for enclosed environments.
- To enhance durability and extend the life of the sealer protecting the stain, consider applying an additional coat of ProWax Polish™ after the sealer has fully cured.
- If you choose to use EasySeal™ indoors, ensure there is sufficient ventilation to maintain good air quality.

SURFACE PROTECTION AND MAINTENANCE

- Periodically inspect the sealed surface for areas where the sealer may be thinning or showing signs of wear due to traffic. Reapply the sealer as needed, following the guidance provided in the appropriate Technical Data Sheet.

- For interior surfaces, the application of ProWax Polish™ is recommended as a sacrificial layer on top of the existing seal coat to enhance protection and appearance. Ensure you obtain and review the appropriate Technical Data Sheet and Safety Data Sheet prior to using this product.

SUITABILITY SAMPLE

Prior to application, prepare a sufficient number of test areas on the actual substrate to determine the aesthetic suitability of the product for its intended use.

LIMITATIONS & PRECAUTIONS

- Batch Variability: The supply of specialized pigments may vary between batches. To ensure color consistency, use the same batch for the entire job or mix multiple batches together (“boxing”).
- Surface Characteristics: Vibrance™ Dye is a translucent stain designed to enhance but not hide the concrete surface. It won't cover discolorations, blemishes, cracks, or other irregularities and may highlight differences in porosity. Typically, it appears lighter when dry than when wet.
- Surface Compatibility: Vibrance™ Dye might not adhere well to hard-troweled (smoothly machine-finished) surfaces or surfaces with pores smaller than its particles.
- Sealant Requirement: Vibrance™ Dye requires a sealer for color enhancement; it is not a standalone sealant product.
- Color Accuracy: While efforts are made to accurately represent colors in product literature, photos, and sample color chips, the actual color achieved on concrete can significantly differ. This discrepancy stems from the stain's translucent nature, allowing the color of the concrete base to affect the final shade.

SLIP RESISTANCE

Vibrance™ Dye does not alter slip resistance. Slip resistance is determined by the chosen sealer. For enhanced slip-resistance on exterior surfaces, integrate OxiGrip™ into the sealer. Ensure you obtain and review the appropriate Technical Data Sheet and Safety Data Sheet prior to using this product.

DISPOSAL

For the disposal of any unused product, please refer to your local environmental or hazardous waste management authority to ensure compliance with local regulations.

SHELF LIFE AND STORAGE

This product should be used within one year of purchase for optimal effectiveness. For storage, keep the product indoors, in a cool area away from direct sunlight and heat sources.

HEALTH & SAFETY GUIDELINES

CAUTION: Avoid contact with eyes and skin. Do not breathe dust. Do not take internally. In case of eye contact, flush thoroughly with water. In case of skin contact, flush thoroughly with water. If swallowed, do not induce vomiting. Call physician immediately.

KEEP OUT OF REACH OF CHILDREN.

WARRANTY

Vibrance™ Dye, a proprietary product, is guaranteed to maintain uniform quality within the bounds of manufacturing tolerances. However, as we have no control over its application, no explicit or implied warranty is provided concerning the effects of such use. In the event of a proven defect, our liability is strictly limited to refunding the purchase price of the defective material. The user is responsible for all other risks and liabilities that may arise from the use of this product. For any inquiries, please reach out to Direct Colors customer service.

AVAILABLE SIZES & PACKAGING

5-Ounce	1-Gallon
1-Quart	5-Gallon

COMPLEMENTARY PRODUCTS

- ProClean Degreaser™ Concentrate Cleaning agent.
- CitrusEtch™ - Concrete etching agent.
- ProClean Neutralizer™ Concentrate.
- EasySeal™ Acrylic Solvent-Based Tinted Sealer
- AcquaSeal™ Acrylic Water-Based Tinted Sealer
- OxiGrip™ Slip resistant Sealer additive
- ProWax Polish™ Premium Floor Wax & Polish

COLOR SELECTION

Vibrance™ Dye is available in 35 colors. For the full range of options, scan the QR code below to view our color chart.



SAFETY DATA SHEET

Scan the QR code below for the complete Safety Data Sheet



TECHNICAL SERVICE & SUPPORT

Direct Colors offers comprehensive technical assistance and consulting services. Our expertise includes product selection guidance, specification details, troubleshooting support, and advice on the effective repair and protection of concrete surfaces. We are committed to providing tailored solutions to meet your specific project needs.