

# ACQUASEAL™ ACRYLIC SEALER

## HOW-TO GUIDE

**DIRECT**  
**COLORS**

### PRELIMINARY TESTING

Before using the product for your entire project, try it out on a small, hidden area of the surface you'll be working on. This will let you see how it looks and if it's the right fit for your project.

### PRE-APPLICATION

- **Clean:** The surface must be entirely free from dust, dirt, oil, grease, paints, glues, non-water-based acrylic sealers, curing agents, efflorescence, chemical contaminants, rust, algae, mildew, and other materials that could prevent proper bonding.
- **Cured:** Ensure the concrete or overlay is fully cured before application. It's recommended that cement-based products cure for at least 28 days for optimal results.
- **Sound:** Only apply to cement-based products that are not flaking or spalling. The substrate must be structurally sound. For surfaces showing signs of delamination, use diamond grinding, shot blasting, or similar mechanical methods for removal.
- **Temperature:** For best results, apply AcquaSeal™ in temperatures ranging from 60°F (15°C) to 95°F (35°C).
- **Profiled:** Perform an absorption test to check if the concrete is ready for sealing. Pour water onto the concrete surface and wait for 3-5 minutes. If the water is not absorbed, the surface will need to be cleaned and etched with **CitrusEtch™** to open the pores of the concrete. Detailed instructions can be found in the CitrusEtch™ Technical Data Sheet. If the concrete absorbs the water, it is ready for AcquaSeal™ application.



### APPLICATION

**WORK AREA PLANNING:** Divide the work area into manageable sections. Use natural breaks like walls and joints to your advantage. Be mindful of maintaining wet edges to reduce the appearance of overlap marks.

### APPLICATION STEPS:

#### For Spraying

- Remove all filters from the pump-up sprayer to prevent clogging.

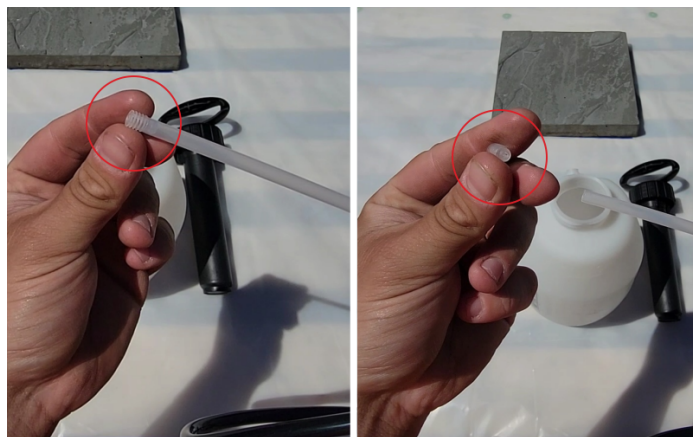

- Apply the product in a circular motion to ensure even coverage. It is important to apply thin layers to avoid puddling and ensure uniform drying.
- Start and stop spraying into a bucket or off the work area to prevent drips. Back roll afterwards to smooth out any puddles or overlaps, maintaining a thin, even layer.

#### For Rolling

- Use a 3/8" nap roller. Allow the roller's weight to apply the product without adding extra pressure, which could cause streaks and uneven coverage. Focus on applying thin, consistent layers.
- Before adding more product to the paint tray, shake the bottle for even consistency.

## DRYING AND RECOATING:

- **Dry Time Between Coats:** Wait 6 to 12 hours, depending on environmental conditions.
- **Testing Dryness:** To check if the surface is ready for the next coat, press with a thumbnail; if the surface doesn't dent or scratch, it's properly dried.
- **Coat Application:** Ensure the first coat is thoroughly dry before applying a second thin coat. The emphasis on thin coats is crucial for achieving the best finish and performance.
- **Recommended Coats:** Two thin coats are advised for best performance and durability.
- **Application Caution:** To prevent bubbling, hazing, and other imperfections, it is essential to apply the product in thin coats rather than heavy applications.
- **Foot Traffic:** Keep the area free from foot traffic for at least 24 hours to allow the topcoat to properly set.
- **Vehicle Traffic:** Avoid vehicle traffic for 48-72 hours to ensure the sealer fully cures and offers maximum protection.

## LIMITATIONS

- **Surface Compatibility:** AcquaSeal™ may experience adhesion challenges when applied to hard-troweled (machine-smoothed) surfaces or surfaces whose pores are smaller than the sealer's particles. This can result in the sealer drying without proper adhesion.
- **Avoid Liquid Contact During Curing:** Prevent any liquids, including sweat, from coming into contact with the uncured coating, as this can affect both the curing process and the quality of the finish.
- **Wear and Tear:** As with all water-based acrylic sealers, AcquaSeal™ is subject to surface wear. Its longevity and durability are contingent upon proper application to a suitably prepared surface, and will also depend on the volume and type of traffic.

## COVERAGE

Estimated coverage is approximately 200 square feet (18.58 m<sup>2</sup>) per gallon. Actual coverage rates may differ based on factors such as surface porosity, texture, the age and condition of the concrete, chosen application method, and prevailing environmental conditions.

## SAFETY & PRECAUTIONS

**CAUTION:** Avoid contact with eyes and skin. Do not take internally. In case of eye contact, flush thoroughly with water. In case of skin contact, flush thoroughly with water. If swallowed, do not induce vomiting. Call physician immediately. **KEEP OUT OF REACH OF CHILDREN.**

## CLEAN-UP

Clean up with ProClean Degreaser™ and water.

## DISPOSAL

For the disposal of any unused product, please refer to your local environmental or hazardous waste management authority to ensure compliance with local regulations.

## SHELF LIFE AND STORAGE

Acquaseal™ should be used within one year of purchase for optimal effectiveness. For storage, keep the product indoors, in a cool area away from direct sunlight and heat sources. Do not allow to freeze.

## MAINTENANCE

**Exterior Surfaces:** Conduct regular inspections of sealed areas for signs of thinning or wear due to foot or vehicular traffic. Reapply sealer as needed to maintain protection and appearance.

**Interior Surfaces:** Regularly examine surfaces with wax coatings or polish for wear or thinning, particularly in high-traffic areas. Reapply the coating as necessary to preserve the surface's integrity and aesthetics.

## WARRANTY

AcquaSeal™, a proprietary product, is guaranteed to maintain uniform quality within the bounds of manufacturing tolerances. However, as we have no control over its application, no explicit or implied warranty is provided concerning the effects of such use. In the event of a proven defect, our liability is strictly limited to refunding the purchase price of the defective material. The user is responsible for all other risks and liabilities that may arise from the use of this product. For any inquiries, please reach out to Direct Colors customer service.